

# \$769,000 - 51 Abu Mousa, La Grange

MLS® #402255

**\$769,000**

4 Bedroom, 2.50 Bathroom, 4,034 sqft

Residential on 0.91 Acres

HARVEST RIDGE, La Grange, New York

The Harvest Ridge community is in the heart of Lagrange, just minutes to the Taconic. Award winning Nesheiwat Builders are in full swing building these custom homes. This model is The Brockett at 2766 sqft for \$769,000 we also have a model that is 2980 sqft for 799,000 with culture stone accent. We have many models to choose from or bring your own plans. Pick your lot and let us build your custom dream home. Our quality built homes have many features included in the price.... stone counters, custom cabinets, gas fireplace in living room, hardwood floors, wall to wall carpet, ceramic tile bathrooms, propane force air heating, central air condition, ceiling lights in all bedrooms, master ensuite includes walk-in closets and ceiling fan, recessed lights in kitchen, 9' ceilings on 1st floor, full basements, blacktop driveways, walkway, deck or patio, landscaped and seeded lawns, town water and septic to name a few. Walk to Stringham Park, minutes to restaurants, gyms, schools and shopping. Call me, I love talking about all the ways that we can make dreams into reality.

Built in 2022

## Essential Information

MLS® #	402255
Price	\$769,000
Bedrooms	4

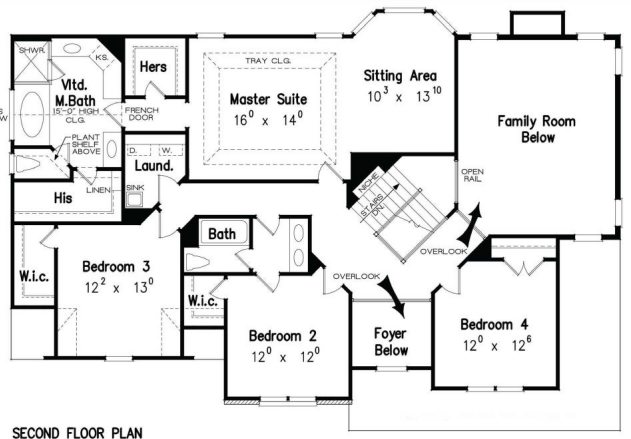
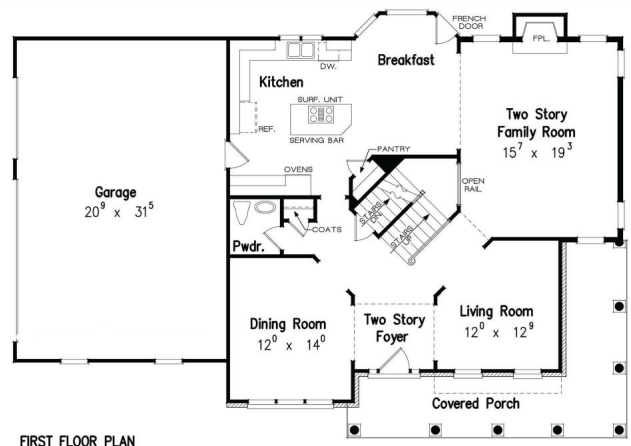

Bathrooms	2.50
Full Baths	2
Half Baths	1
Square Footage	4,034
Acres	0.91
Year Built	2022
Type	Residential
Sub-Type	Single Family Detached
Style	Colonial
Status	ACTIVE

### Community Information

Address	51 Abu Mousa
Area	DUTCHESS COUNTY
Subdivision	HARVEST RIDGE
City	La Grange
County	Dutchess County
State	New York
Zip Code	12540

### Amenities

Parking	2 Cars
# of Garages	2
Waterfront	None

### Interior

Interior	Ceramic Tile, Wall to Wall Carpet, Wood
Interior Features	9+ Foot Ceilings, Electric Dryer Connection, Sliding Glass Doors, Washer Connection, Walk-In Closets
Appliances	None
Heating	Forced Air, Propane
Cooling	Central Air
Fireplace	Yes
# of Fireplaces	1
# of Stories	2

### Exterior

Exterior	Vinyl
Exterior Features	Deck, Landscaped, Patio, Porch

Lot Description	Level
Roof	Asphalt Shingles
Construction	Frame
Foundation	Concrete

**School Information**

District	Arlington Central
Elementary	Noxon Road Elementary School
Middle	Union Vale Middle
High	Arlington High School

**Listing Details**

Listing Office	BHHS HUDSON VALLEY PROPERTIES LG
----------------	----------------------------------

The data relating to real estate for sale or rent on this web site comes from the Mid-Hudson Multiple Listing Service, LLC. IDX information is provided exclusively for consumers' personal, non-commercial use, that it may not be used for any purpose other than to identify prospective properties consumers may be interested in purchasing. Information deemed reliable but not guaranteed and should be verified. Copyright 2024 Mid-Hudson Multiple Listing Service, LLC. All rights reserved.